

Parts List

Ref	Class	Part	Description	Qty	Comment	Footnote
1	27	828553	GASKET	1		1,2
2	1171	9812A 8	LOWER END CAP ASSEMBLY	1		3,2
3	26	828932	OIL SEAL	1		2
4	26	41953	OIL SEAL	1		2
5	25	90011	O-RING	1		1,2
6	10	817427 20	SCREW (M8 X 20)	3		2
7		19077A 6	BRACKET ASSEMBLY	1		2
8	16	816194 6	STUD	2		2
9	12	49221	WASHER	2	ELECTRIC	
10	12	69056	WASHER	2	ELECTRIC	
11	11	816872	WING NUT	2	ELECTRIC	
12	10	821273 35	SCREW (M8 X 35)	4		2
13	12	814806	WASHER (USE WHERE APPLICA	1	(BOTTOM LEFT ONLY)	2
14		827998A 1	INDUCTION MANIFOLD	1		2
15	22	19725	ELBOW	1	(ELECTRIC)	2
16	22	19725	ELBOW	3	(MANUAL)	2
17	22	15026	CAP	1	(MANUAL)	2
18	54	816311	STA STRAP	1		
19	27	812869	GASKET	1		1,2
20	10	817427 30	SCREW (M8 X 30)	10		2
21		19075A 3	REED BLOCK ASSEMBLY	1		2
22	27	812868	GASKET	1		1,2
23		NSS	DOWEL PIN	6		4,2
24	34	812880A 2	REED SET	3		2
25	14	42982	TAB WASHER	3		2
26		812879 1	RETAINER	3	(50)	2
27		825267	REED STOP	3	(40)	2
28	10	40001 71	SCREW (M6 X 16)	3		2
-		852067A98	POWERHEAD	1		3
-	27	828553A97	GASKET SET	1		

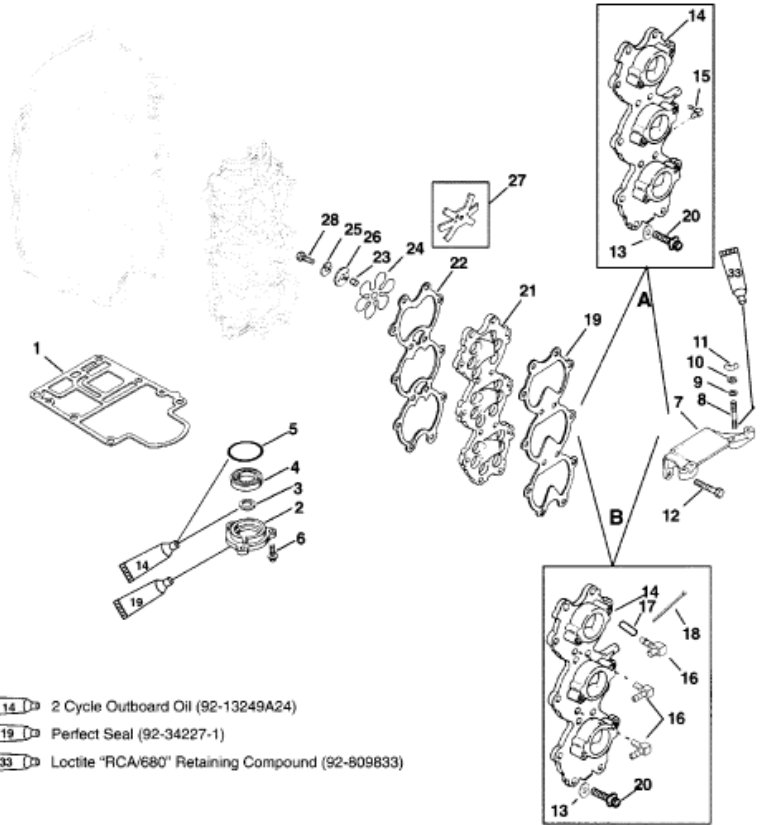

- 14 2 Cycle Outboard Oil (92-13249A24)
- 19 Perfect Seal (92-34227-1)
- 33 Loctite "RCA/680" Retaining Compound (92-809833)

A= electric      B = manual